

# Rail Lifters - Replacement Parts

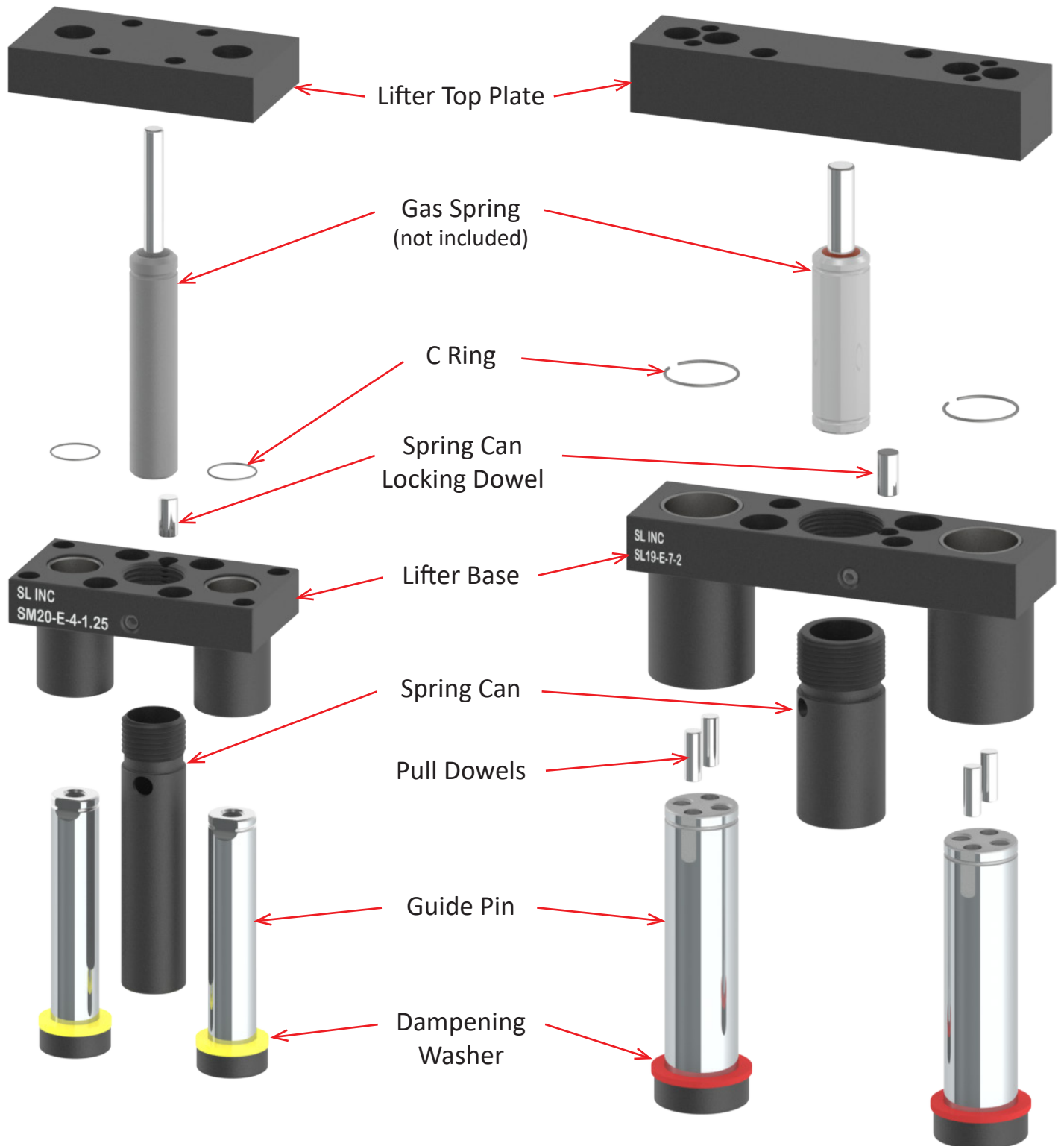

# Rail Lifters - Replacement Parts

## Bases

The etching on Bases have all of the information necessary for ordering replacement bases.



Lifter Series	English/ Metric	Base Length	Bushing Below Base	
SM12	M	5.38	1.25	Base
Example: <b>SM12-M-5.38-1.25-Base</b>				

## Top Plates

"A" Style Top Plates are the same Width and Length as the Base Plate. In most cases additional Machining features will need to be performed to attached other details.

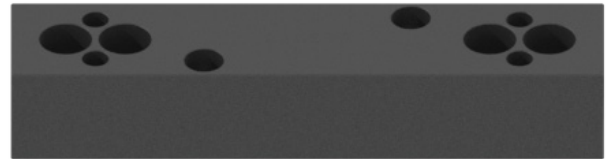

Lifter Series	English/ Metric	Base Length	Top Plate Style	
SM12	M	5.38	A	TopPlate
Example: <b>SM12-M-5.38-A-TopPlate</b>				

## Guide Pins

### SM Series

.75" OD

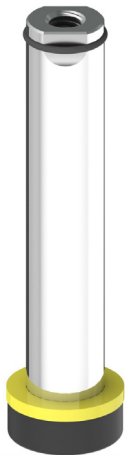

All of the information necessary for ordering replacement Guide Pins is etched on the head of the Guide Pin.

### SL Series

1.25" OD



## Spring Can

### SM Series (MSR75)



### SL Series (MSR100)



Type	Overall Length	
MSR75	1.75	SpringCanBody
Example: <b>MSR75-1.75-SpringCanBody</b>		



# Rail Lifters - Replacement Parts

Series	Base Length	Replacement Parts
SM	ALL	GK75- <i>M for Metric or E for English</i> - <i>Pin Length</i> -GuidePin
		MSR75- <i>Overall Spring Can Length</i> -SpringCan
		Cring-.039CS-.655ID-.733OD-.10Gap (Steel C Ring)
		DampeningWasher-95A-Yellow-0.75-1.125-0.125 (Washer)
		CapScrew-Standard-Patched-M10_1.5-25mm (for Metric TopPlates/Pins)
		CapScrew-Standard-Patched-.375_16-1 (for English TopPlates/Pins)
SM12	5.38"	SM12- <i>M for Metric or E for English</i> -5.38-.5-Base
		SM12- <i>M for Metric or E for English</i> -5.38-1.25-Base
		SM12- <i>M for Metric or E for English</i> -5.38-A-TopPlate
	9.00"	SM12- <i>M for Metric or E for English</i> -9-.5-Base
		SM12- <i>M for Metric or E for English</i> -9-1.25-Base
		SM12- <i>M for Metric or E for English</i> -9-A-TopPlate
	14.00"	SM12- <i>M for Metric or E for English</i> -14-.5-Base
		SM12- <i>M for Metric or E for English</i> -14-1.25-Base
		SM12- <i>M for Metric or E for English</i> -14-A-TopPlate
SM20	4.00"	SM20- <i>M for Metric or E for English</i> -4-.5-Base
		SM20- <i>M for Metric or E for English</i> -4-1.25-Base
		SM20- <i>M for Metric or E for English</i> -4-A-TopPlate
SL	ALL	SL- <i>M for Metric or E for English</i> - <i>Pin Length</i> -GuidePin
		MSR100- <i>Overall Spring Can Length</i> -SpringCan
		Cring-.063CS-1.116ID-1.242OD-.25Gap (Steel C Ring)
		DampeningWasher-95A-Red-1.25-1.75-0.113 (Washer)
		CapScrew-Standard-Patched-M10_1.5-35mm (for Metric TopPlates/Pins)
		CapScrew-Standard-Patched-.375_16-1.5 (for English TopPlates/Pins)
SL19	7.00"	SL19- <i>M for Metric or E for English</i> -7-.75-Base
		SL19- <i>M for Metric or E for English</i> -7-2-Base
		SL19- <i>M for Metric or E for English</i> -7-A-TopPlate
	12.00"	SL19- <i>M for Metric or E for English</i> -12-.75-Base
		SL19- <i>M for Metric or E for English</i> -12-2-Base
		SL19- <i>M for Metric or E for English</i> -12-A-TopPlate
	18.00"	SL19- <i>M for Metric or E for English</i> -18-.75-Base
		SL19- <i>M for Metric or E for English</i> -18-2-Base
		SL19- <i>M for Metric or E for English</i> -18-A-TopPlate

