

STANDARD LIFTERS

MAKING INNOVATION THE STANDARD



Guided Keeper - Advantages/Applications

Guidance / Retention ALL IN ONE

Less Parts = Less Space = Less Machining



Anti-Loosen Guide Pin Connections



Full Featured Guide Pins

In stock lengths every .125"

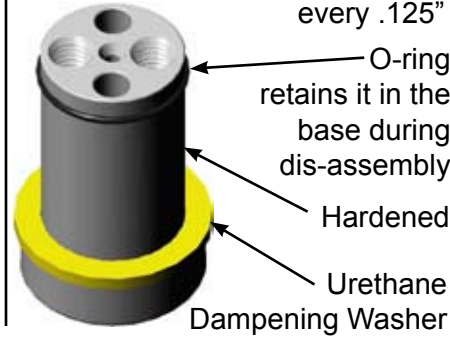

Cost Effective

Starting at \$80 complete

Stripper Pads

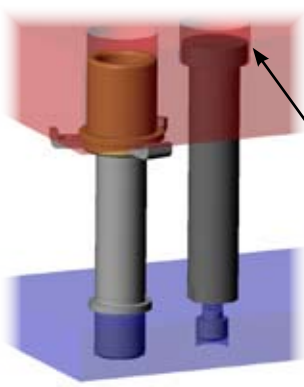

Old Method

Large amount of space and machining required ... including a c'bore on the backside ... prone to loosen spools

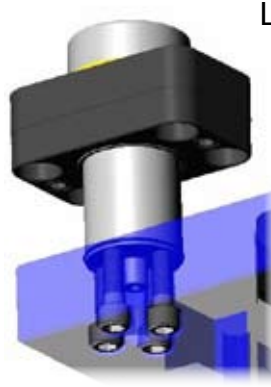

Less Space Required

New Method

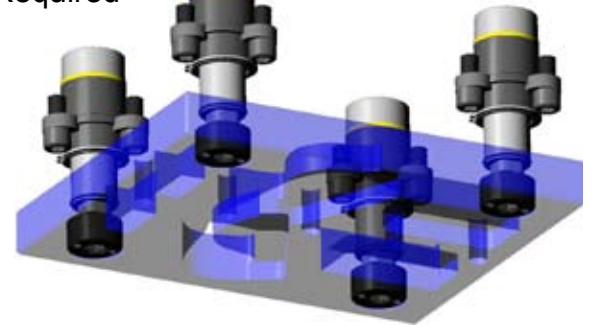

Contour Pads

Custom Made ...
Labor Intensive ...
Costly repairs

- Machine
- Heat Treat
- Grind

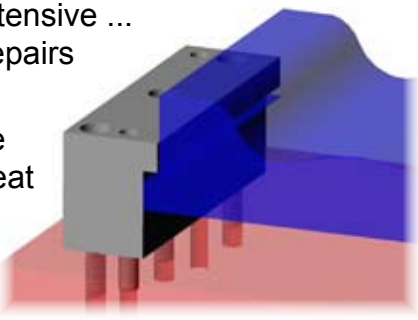

Old Method

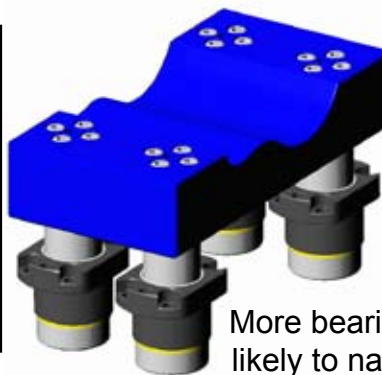

New Method

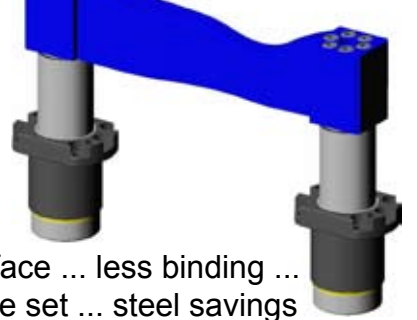

More bearing surface ... less binding ... likely to narrow die set ... steel savings

Lifter Rails

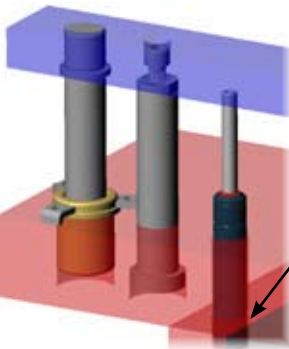

Old Method

Backside machining ... flat bottom holes in parallels to retain springs ... spools fall through during dis-assembly



All in One ... includes "flat bottom hole" for spring

New Method

